

PPS70 SFC

Portable Solar PPS Unit

Key Features

- Easy and reliable solar panel connection
 - Allows easy solar photovoltaic (PV) connection for battery charging
- Embedded USB charging ports
 - 3 x 5V USB charging ports for mobile devices
- Overload protection
 - Overload protection in battery mode and short circuit protection
- Off mode charging



PPS70SFC Portable Solar (PPS) unit is a compact and user-friendly lighting solar power supply unit that is suitable for use in home / outdoor settings. This portable-sized unit may appear small but it comes with an amazing 230VDC output that can be used for powering up energy saving light bulbs or LED bulbs of up to 11W. In addition, there is also a 5VDC USB port for charging your mobile devices and a 12VDC round pin connector for equipment such as DC fans. The unit is designed with the flexibility to be powered by regular AC supply, solar PC modules or via the supplied battery.

PPS70SFC Portable Solar unit gives you the privilege and freedom to double up your backup duration by adding another block of 7AH battery on top of the existing supplied battery. The PPS is the perfect device for use in rural locations where the power supply is often inconsistent and unstable.



Front View

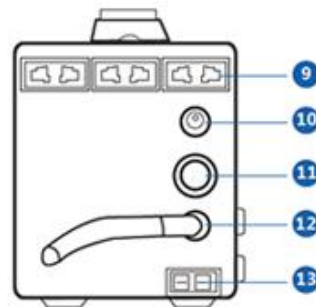

Back View

Legend:

- | | |
|--|--|
| 1 1A/2A Charger Select | 7 Main Power Switch |
| 2 Energy Saving Lighting On/Off Switch | 8 PV Input |
| 3 Charging Status Indicator | 9 Energy Saving Light Output Receptacles |
| 4 Battery Status Indicator | 10 12VDC Output Connector |
| 5 Fault Indicator | 11 2A AC Fuse |
| 6 USB Charger Ports | 12 AC Input |
| | 13 External Battery Connector |

How it work?



SPECIFICATION

Capacity		70W
Input	Voltage Range Frequency Phase	230VAC 50 Hz or 60Hz (Auto-sensing) Single + GND
Output	Output Voltage (AC Mode) Output Voltage (Batt Mode) Waveform	230VDC 160VDC ~ 230VDC ±10% DC Output
Battery	Battery Voltage Battery Capacity	12VDC 7AH
PV Input	PV Array Open Circuit Voltage (Maximum) Solar Charging Current (Maximum)	30VDC 2A
Protection/Monitoring	Short Circuit Protection Overload Protection Alarm	Yes Yes LED Indication
General	Temperature Humidity	0°C ~ 40°C 0 ~ 90% relative Humidity (Non-condensing)
Physical	Dimension (DxHxH) mm Weight kgs	229 x 110 x 123.5 3.8



Dealer's information:

THRiVE
SOLAR ENERGY
PHILIPPINES

info@thrivesolarenergyphilippines.com
www.ThriveSolarEnergyPhilippines.com